

### OPTIMUS CRUX LITE - extremely lightweight-gas canister stove

#### PRODUCT CHARACTERISTICS

Gas:	Butane/isobutane/propane
ø Burn time:	Up to 90 minutes at full power (230 g gas cartridge)
ø Boil time:	approx. 3 minutes for 1 L water
Output:	3'000 Watt 10'200 BTU/h
Weight:	72 g / 2.5 oz
Dimensions:	71 x 57 x 56 mm
Guarantee:	2 years
Material:	Stainless steel, aluminum
Accessories:	storage bag
Article No.:	8019259 Optimus Crux Lite



#### FACTS

- With a mere 72 g, one of the lightest stoves in the world
- Powerful and stable 3'000 Watt burner for efficient cooking
- Large burner head for optimal heat distribution
- Precise flame control – simmering without burning

### OPTIMUS CRUX LITE - extremely lightweight-gas canister stove

#### EXPLODED VIEW

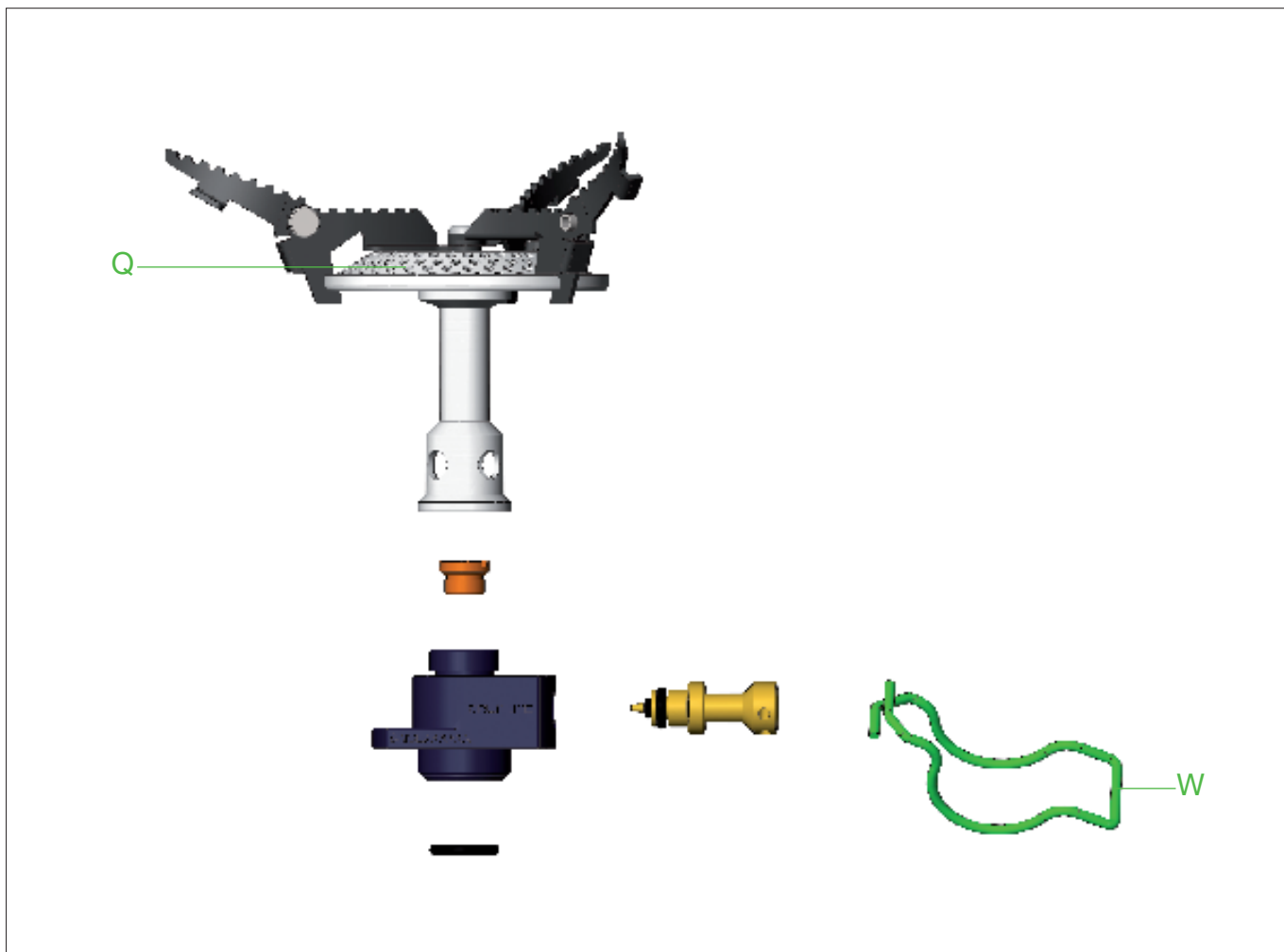

Q Burner head

W Control handle

Katadyn reserves the right to modify product characteristics  
Version: 23.09.2021

**Katadyn Products Inc.** | Pfäffikerstrasse 37 | 8310 Kemptthal | Switzerland  
Tel: +41 44 839 21 11 Fax: +41 44 839 21 99  
info@katadyn.ch | [www.optimusstoves.com](http://www.optimusstoves.com)